

CHILLER COOLER HOCKEY

Assembly Instructions

STK #98633

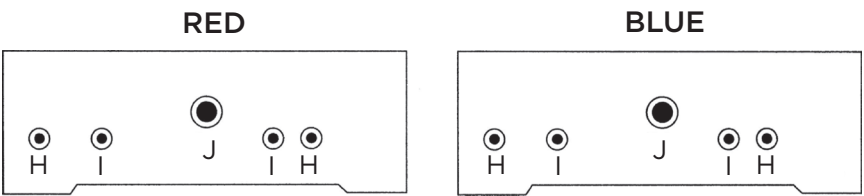

Step 3: Install the goals (D) and score bars (E). Assemble all the players (F) and Goalie (G) and connect them to the rods with the Gear Post (C). Arrange players (F) and goalies (G) according to the following image:

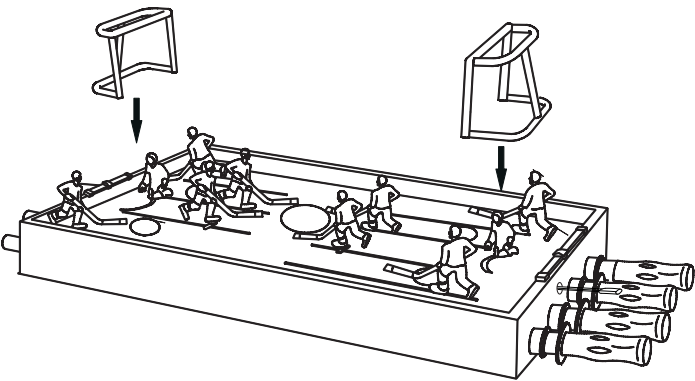

Step 4: Lastly, place the hockey table atop the cooler.

CHILLER COOLER HOCKEY

Assembly Instructions

STK #98633

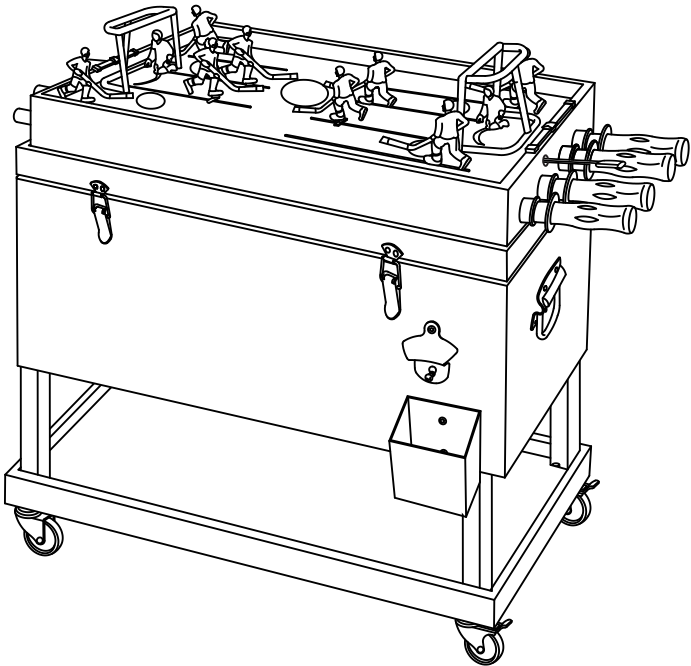

Assembly Tips

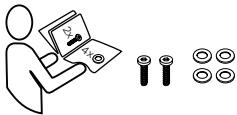

Count
all pieces and hardware
before assembling.

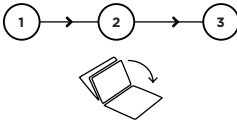

Review
the instructions from
beginning to end before
getting started.

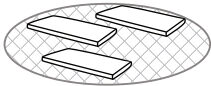

Make Space
Keep plenty of clear
space and use a clean rug
or drop cloth if needed.

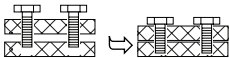

Double Check
that all pieces are in place before
tightening screws. This ensures
quick assembly.

CHILLER COOLER HOCKEY

Assembly Instructions

STK #98633

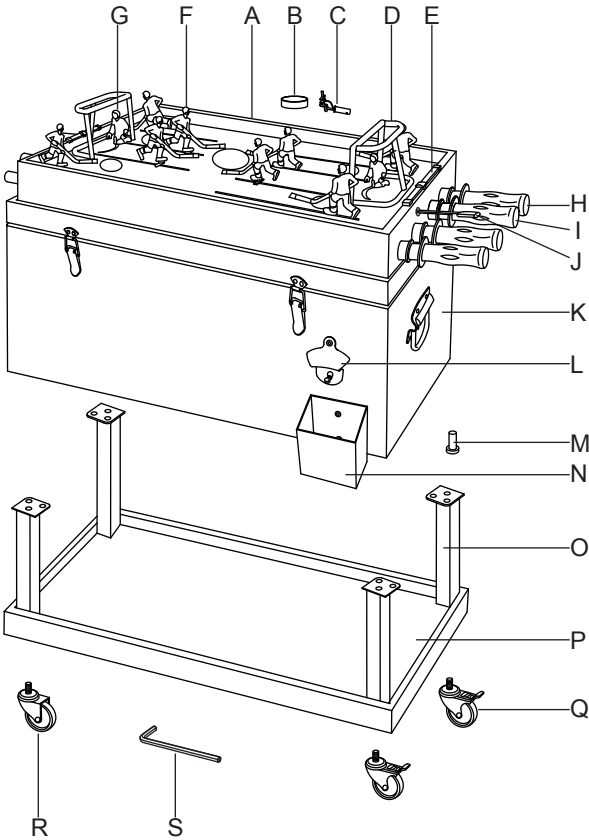

NO.	DESCRIPTION	QTY
A	Hockey Base	1
B	Puck	2
C	Player Gear Post	10
D	Goal	2
E	Score Bar	2
F	Player	8
G	Goalie	2
H	Long Hockey Rod	4
I	Short Hockey Rod	4
J	Goalie Hockey Rod	2
K	Cooler Body	1
L	Bottle Opener	1
M	Bottler-cap Catcher	1
N	M6*16 Bolts	12
O	Legs	4
P	Bottom Tray	1
Q	Casters with Lock	2
R	Casters without Lock	2
S	M6 Wrench	1

CHILLER COOLER HOCKEY

Assembly Instructions

STK #98633

ASSEMBLY:

Put all parts on a clear and level surface before assembling.

Step 1: Place the cooler body(K) upside down, Connect the legs (O) to body using bolts (M). Do not tighten the bolts completely. Before the tray (P) and casters can be installed:

Step 2: Place the tray (P) on the legs and screw the casters to the legs (O) through the tray (P). Tighten bolts with the M6 Wrench (S). The casters with lock (Q) can be placed on the same side or diagonally across from the ones without lock (R).

Step 3: Turn the assembled piece upright. Attach the bottle opener (L) onto the body and tighten then by two M6*16 bolts (N). Install 2 pc bolts and attach bottlecap catcher (M) on them.

HOCKEY GAME ASSEMBLY:

Step 1: Turn hockey base (A) upside down.

Step 2: Install all the hockey rods (H), (I), (J) and player gear post (C) according to the diagram.

