

KITCHEN STUFF

BAKERS

GLASS DIGITAL KITCHEN SCALE

USER'S MANUAL

STK 92071
STK 92072
STK 92073
STK 92074

* Please note that diagrams may vary based on different models

- To change the units of measurement press the 'UNIT' button and cycle through until the desired unit is found.

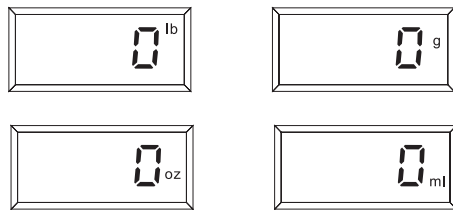

- Place your item on the scale. The weight will be shown on the screen.

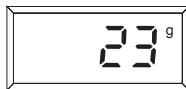

- Use the 'TARE' function to clear the weight of the item on the scale. This is useful when you want to measure the weight of a product but not the weight of the container holding the product. First place the container on the scale, then press the 'TARE' button, the LCD will revert to 0g, place your product in the container and the scale will measure only the added weight of the product.

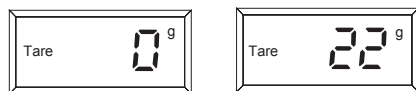

- 3 -

Thank you for choosing our Kitchen Stuff Bakers Glass Digital Kitchen Scale. To ensure proper operation and to maintain the lifespan and the accuracy of the scale, please read this manual carefully before use.

KEY FEATURES

- Min 3g - Max 5000g (5kg)
- Tare function for measuring multiple ingredients
- Auto power off
- Low battery and over load indicator
- Units of measure are g/oz/lb:oz/ml
- Requires 1x CR2032 battery (included)
- Easily switch from grams to oz

BUTTONS

- UNIT: Switches between units of measurement (g/oz/lb:oz/ml).
- ⏻/T: Powers on and powers off the unit. Activates Tare function.



- 1 -

- You can use the TARE function several times in order to weigh additional product separately – great for adding ingredients to a mixing bowl!

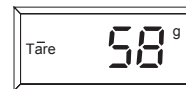

- To turn off the scale when you're finished measuring just press the ⏻/T button until the screen shows 0g. The scale will automatically turn off after a few seconds of inactivity.

CAUTION

- When 'Lo' appears on the screen please change the battery.

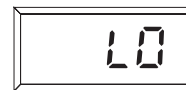

- If 'EEEE' appears on the screen this indicates an overload. Remove all items from the scale and allow it to reset before trying again.

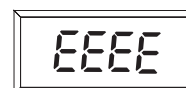

- 4 -

OPERATION

- Take the insulating strip out before using.

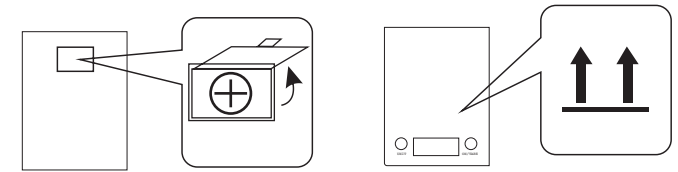

- Place scale on hard, level surface such as a table or countertop.
- Press the ⏻/T button to turn the scale on. The LCD display will show "0" when ready.

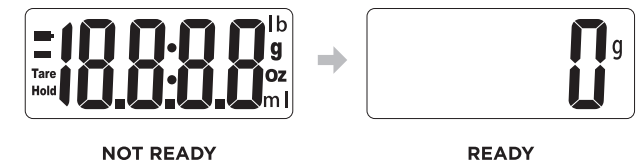

- 2 -

ATTENTION

- Place scale on hard, level surface and ensure it is steady before using.
- The maximum capacity of the scale is 5 kg, which is the capacity before using the tare function.
- To clean simply wipe with a soft damp cloth. Keep away from water, corrosive liquid, heat and extreme coldness.
- The KSP Bakers Kitchen Scale is a precision measuring device, do not drop or disassemble the unit.
- The KSP Bakers Kitchen Scale is intended for home use only and is not designed for the constant use of a professional kitchen.
- If the KSP Bakers Kitchen Scale malfunctions please check the battery and change if necessary.



- 5 -