

IMPORTANT SAFEGUARDS

- Basic safety precautions should always be followed when using electrical products, especially when children are present.
- To avoid the risk of electrical shock, always make sure the product is unplugged from the electrical outlet before relocating, servicing, or cleaning it.
- This product is intended for grinding coffee beans to brew coffee for human consumption.
- Do not use the product for any other purpose.
- Keep the product out of the reach of children and pets. This product is not intended for use by children. Close adult supervision is necessary when this product is used near children.
- Do not leave the product unattended while in use. Always unplug the product from the electrical outlet when not in use.
- Always place the product on a flat, steady, stable surface.
- Keep the power cord and product away from heated surfaces.
- Do not place this product in or expose it to water or other liquids.
- Do not use attachments not recommended or sold by the product manufacturer as a risk of fire, electrical shock, or serious personal injury may result.
- Do not touch moving parts (the grinding blades) while the product is in use.
- To avoid the risk of serious personal injury or damage to the product, keep hands, hair, other body parts, clothing, and utensils away from the grinding blades while operating the product.
- Plug the product into a standard 220-240v AC electrical outlet.
- Never plug the product into an electrical outlet unless it is completely assembled, and the lid is securely in place.

- Never activate the coffee grinder without the lid in place. Do not bypass the safety functions of the pulse button.
- Before removing the lid, unplug the product from the electrical outlet blades have completely stopped. And make sure the grinding.
- Do not plug or unplug the product into/from the electrical outlet with a wet hand.
- Do not allow the power cord to hang (i.E., Over the edge of a table or counter) where it tripped over or pulled.
- Unplug the product from the electrical outlet prior to putting on or removing parts.
- Never operate this product if it has a damaged power cord or plug, is not working properly, has been dropped, damaged, or if the motor housing has been exposed to water or other liquids. Do not attempt to examine or repair this product yourself. Only qualified service personnel should perform any servicing. Return the product to a service center for examination and repair.
- This product is intended for indoor, non-commercial, household use only. Do not use outdoors.

ATTENTION

- This product is equipped with a polarized plug (one blade is wider than the other blade) as a safety feature to reduce the risk of electrical shock. This plug will fit into a polarized outlet only one way. If you are unable to insert the plug into the electrical outlet, try reversing the plug. If the plug still does not fit, contact an electrician. Never use the plug with an extension cord unless the plug can be fully inserted into the extension cord. Do not alter the plug.
- Do not attempt to defeat the safety purpose of the polarized plug.
- A short power cord is provided to reduce the risk of personal injury resulting from becoming

entangled in or tripping over a longer cord.

- If an extension cord is used: (1) the marked electrical rating of the extension cord should be at least as great as the electrical rating of the product; (2) the extension cord should be arranged so that it will not drape over the countertop or tabletop where it can accidentally be pulled on or tripped over by children or pets.

NOTES

Before using the coffee grinder for the first time, thoroughly clean the lid and the Container. (Reference the "Care and Maintenance" section): then thoroughly dry them.

Remove any foreign objects or debris from the Container before each use.

CARE AND MAINTENANCE

Ensure the product is unplugged from the electrical outlet before cleaning it.

- Clean the grinder container after every use.
- Wash the Lid in warm, soapy water; then rinse and dry thoroughly.
- Wipe clean the inside of the grinder with a soft, damp cloth; then thoroughly dry them.

Do not immerse the grinder into water or any other liquids.

- Do not use abrasive cleaners or scouring pads to clean the product.
- Do not oil or sharpen the grinding blades.
- Store the product in a cool, dry place.

DETAILS

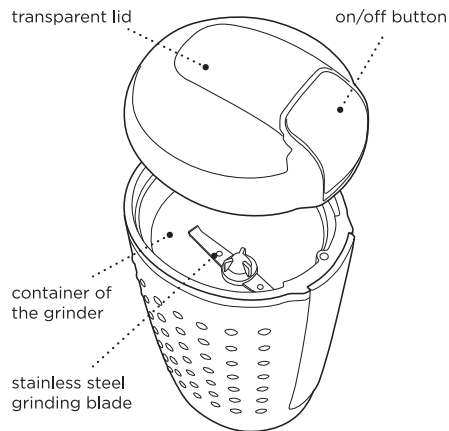

STEP 1

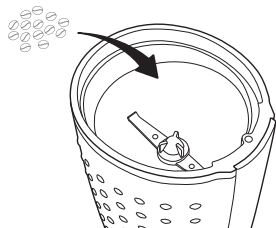

Fill

1. Remove lid.
2. Fill the container with coffee beans. The coffee grinder has a capacity of 3 oz. (80 g).
Do not fill the coffee grinder beyond the brim of the container.
3. Securely close the lid.

STEP 2

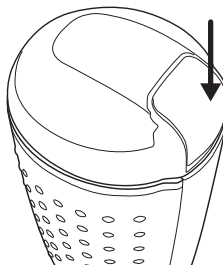

Grind

1. Press and hold on/off button down the button to begin grinding.

Do not hold down the button for more than one minute to avoid overheating the product. The grinding time may vary depending of coffee beans.

STEP 3

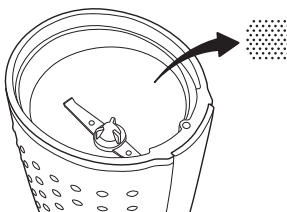

Done

1. Release the button.
- Wait until the blades have completely stopped before removing the lid.**
2. Pour the coffee grounds into the coffee filter of your coffeemaker.
 3. Unplug the product when not in use.

STK# 94799 / STK# 94800

PERK COFFEE GRINDER INSTRUCTION MANUAL

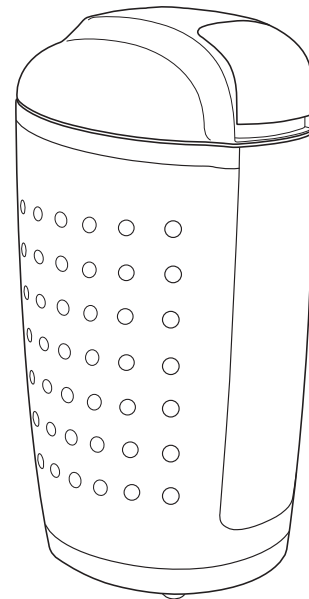

Read all instructions before use.